

ISO VIEW

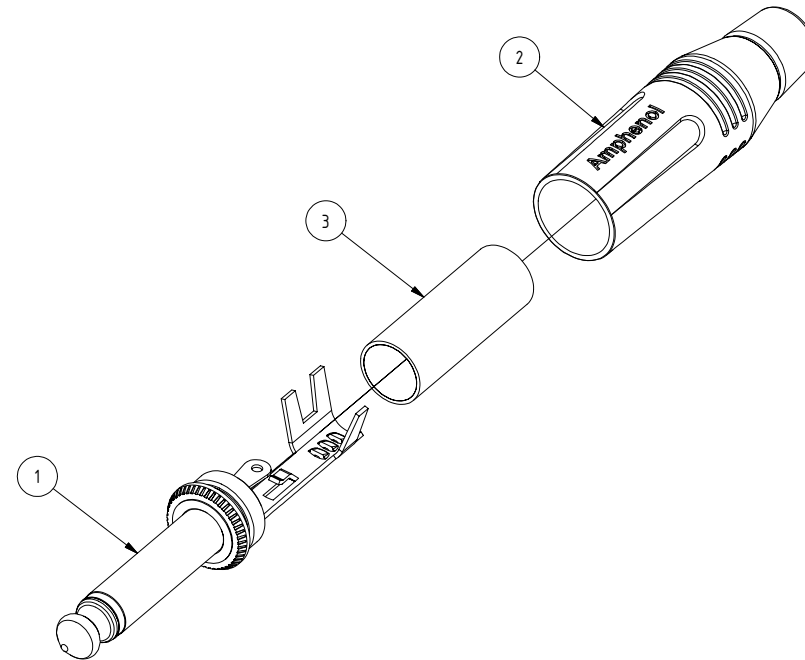

Parts List				
ITEM	PART NUMBER	DWG No	DESCRIPTION	QTY
1	50310007-*30	50310007-130-1	INSERT ASSEMBLY	1
2	53490001-*31	53490001-331-1	BACKSHELL ASSEMBLY	1
3	51270016-521	51270013-521-1	PVC INSULATION TUBE	1

Part Numbers According to Shell and Contact Finish			
CATALOGUE P/No	REFERENCE P/No.	SHELL FINISH	CONTACT FINISH
ACPM-GN	55010218-000	NICKEL	NICKEL SLEEVE AND TIP
ACPM-GN-AU	55010218-001	NICKEL	GOLD SLEEVE AND TIP
ACPM-GB	55010218-002	BLACK	NICKEL SLEEVE AND TIP
ACPM-GB-AU	55010218-003	BLACK	GOLD SLEEVE AND TIP

UNLESS OTHERWISE SPECIFIED TOLERANCE TO BE		THIS DOCUMENT IS THE PROPERTY OF AMPHENOL AUSTRALIA PTY LTD. NO PART THEREOF MAY BE REPRODUCED AND USED WITHOUT THE PRIOR WRITTEN CONSENT OF THE OWNER				1	UPDATE TO MODIFIED COMPONENTS	LV	1/03/2004	8241
LINEAR		ANGULAR		CAD FILE: 55010218000111		0	FIRST ISSUE	T.N	7/12/2002	----
X ± 0.5	X <sub>1</sub> ± 1	X'X' ± 30'		DSD:	T.N	CHANGE DETAILS		BY	DATE	CHG/No
XX ± 0.1	XX' ± 30'	X'X' ± 15'		MATL:	REFER TO COMPONENTS	DATE:	04-05-04	TITLE: 1/4" PHONE PLUG MONO ASSY		
BREAK ALL SHARP EDGES AND REMOVE ALL BURRS		FINISH:		APP'D:	P.M	DATE:		DRAWING NO. 55010218-000-1		
DO NOT SCALE		SCALE:		THIRD ANGLE PROJECTION		SCALE: 2:1 UOS		PART No: SEE TABLE		SHEET 1/1
DIMENSIONS IN MILLIMETRES		SCALE:		SCALE: 2:1 UOS		PART No: SEE TABLE		SIZE: A3		55010218-000-1

**Amphenol**  
Amphenol Australia Pty Ltd, 2 Fineways Blvd, Keysborough, Vic3173

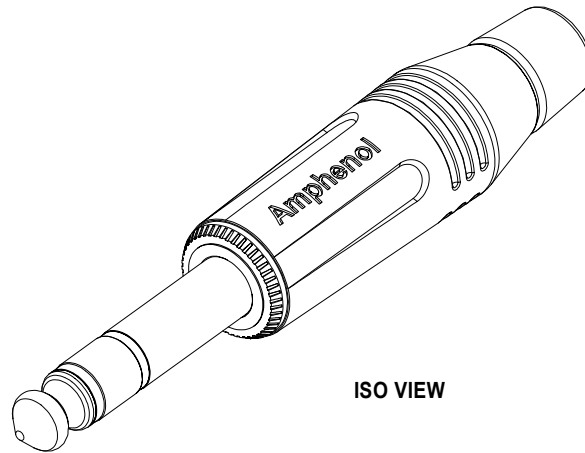
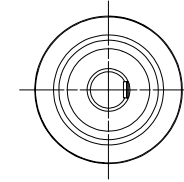
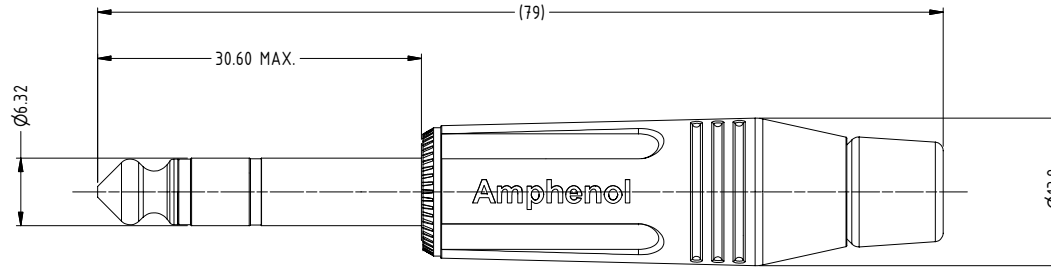

ISO VIEW

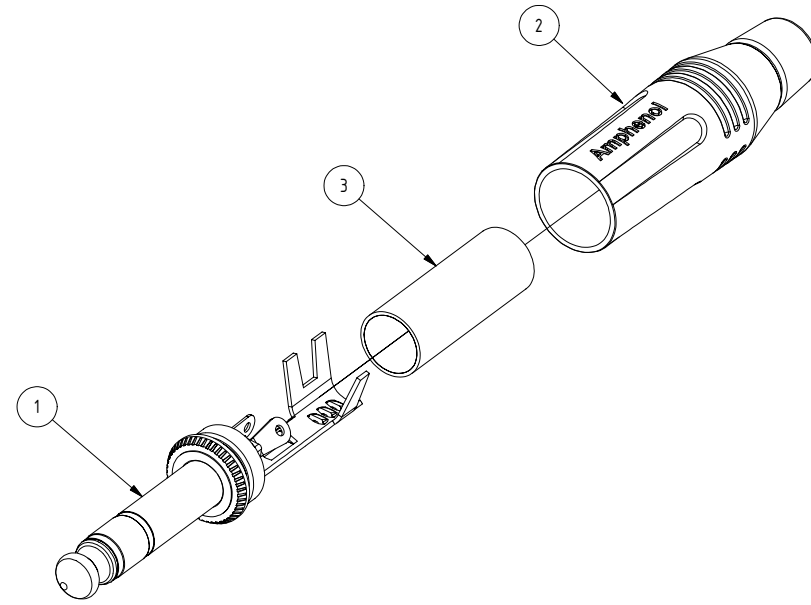

Parts List				
ITEM	PART NUMBER	DWG No	DESCRIPTION	QTY
1	50310006-*30	50310006-130-1	INSERT ASSEMBLY	1
2	53490001-*31	53490001-331-1	BACKSHELL ASSEMBLY	1
3	51270016-521	51270013-521-1	PVC INSUALTION TUBE	1

Part Numbers According to Shell and Contact Finish			
CATALOGUE P/No	REFERENCE P/No.	SHELL FINISH	CONTACT FINISH
ACPS-GN	55010217-000	NICKEL	NICKEL RING, SLEEVE AND TIP
ACPS-GN-AU	55010217-001	NICKEL	GOLD RING, SLEEVE AND TIP
ACPS-GB	55010217-002	BLACK	NICKEL RING, SLEEVE AND TIP
ACPS-GB-AU	55010217-003	BLACK	GOLD RING, SLEEVE AND TIP

UNLESS OTHERWISE SPECIFIED TOLERANCE TO BE		THIS DOCUMENT IS THE PROPERTY OF AMPHENOL AUSTRALIA PTY LTD. NO PART THEREOF MAY BE REPRODUCED AND USED WITHOUT THE PRIOR WRITTEN CONSENT OF THE OWNER				1	UPDATE TO MODIFIED COMPONENT	LV	1/03/2004	8241
LINEAR		ANGULAR		CAD FILE: 55010217000111		0	FIRST ISSUE	T.N	21/11/2002	----
X ± 0.5	X ± 1	DATE: 21/11/2002		DSD: T.N		CHANGE DETAILS		BY	DATE	CHG/No
XX ± 0.1	XX ± 30'	DATE: 04-05-04		M.N.H		TITLE: 1/4" PHONE PLUG STEREO ASSY		Amphenol Australia Pty Ltd, 2 Fineways Blvd, Keysborough, Vic3173		
XXX ± 0.05	XXX ± 15'	DATE: 04-05-04		P.M		DRAWING NO.		SHEET		
BREAK ALL SHARP EDGES AND REMOVE ALL BURRS		MATERIAL: REFER TO COMPONENTS		APP'D: P.M		PART No: SEE TABLE		SIZE: A3		1/1
DO NOT SCALE		FINISH: SEE TABLE		SCALE: 2:1 UOS		DRAWING NO. 55010217-000-1		SHEET 1/1		
DIMENSIONS IN MILLIMETRES		THIRD ANGLE PROJECTION		SCALE: 2:1 UOS		PART No: SEE TABLE		SIZE: A3		1/1

**Amphenol**

Amphenol Australia Pty Ltd, 2 Fineways Blvd, Keysborough, Vic3173

DRAWING NO. 55010217-000-1 SHEET 1/1

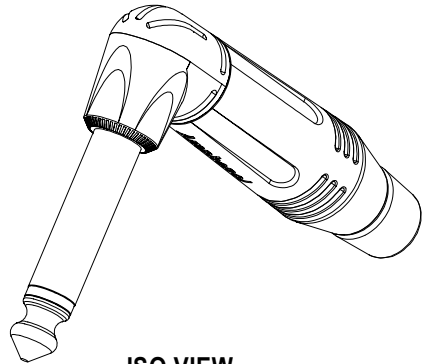
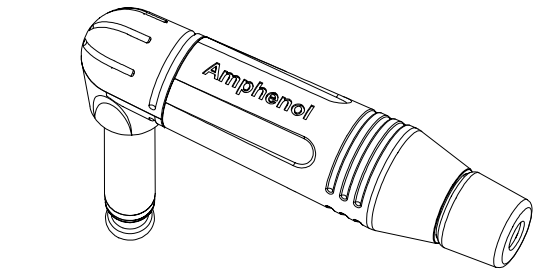

ISO VIEW

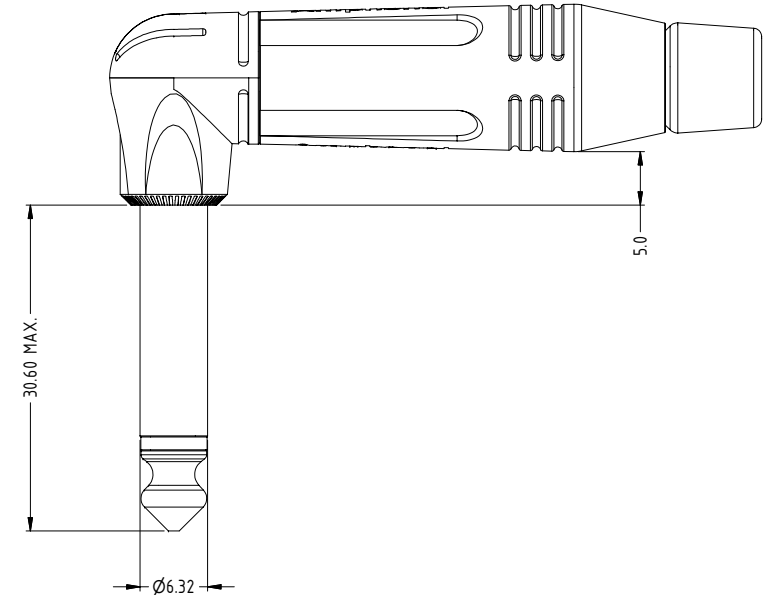
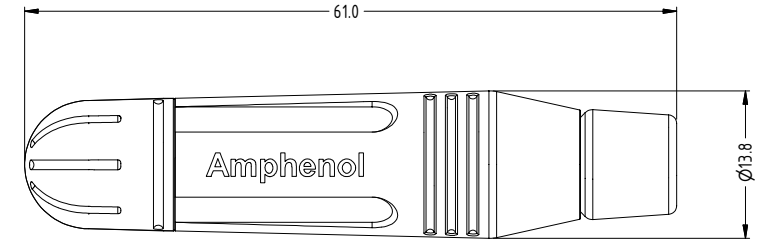
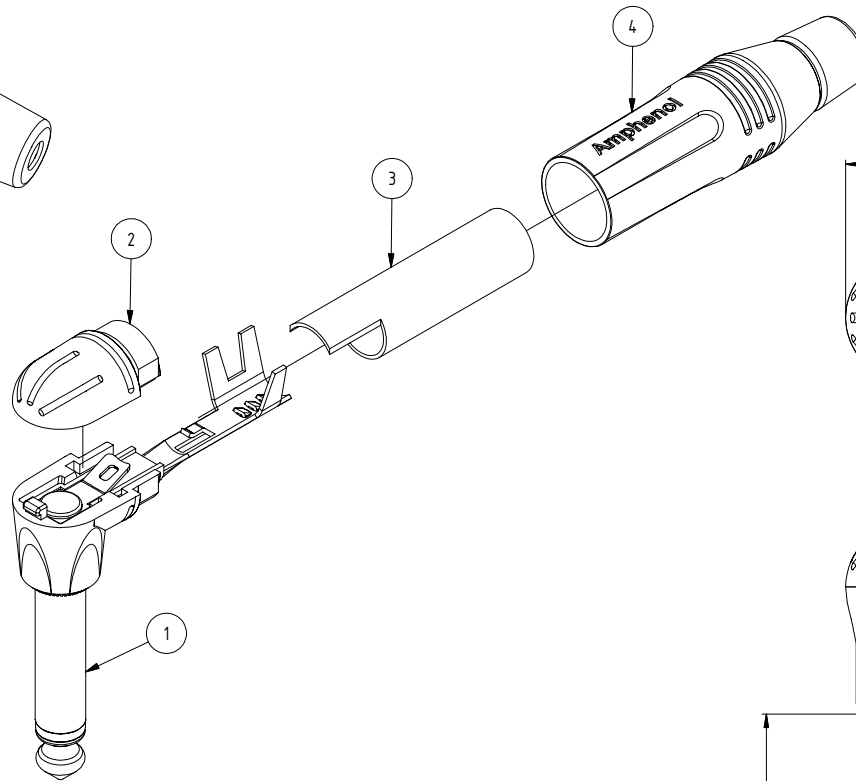

Mono Connector Assembly - Parts List				
ITEM	PART NUMBER	DWG No	DESCRIPTION	QTY
1	50310028-*30	50310028-130-1	RA-MONO PLUG INSERT CONTACT ASSEMBLY	1
2	50300105-*21	50300105-121-1	RA-TOP CAP	1
3	51270031-521	51270031-521-1	RA-BIG TUBE PVC INSULATOR	1
4	53490001-*31	53490001-331-1	M-SERIES BACKSHELL ASSEMBLY	1

Part Number according to Shell and Contact Finish			
CATALOGUE P/No.	REFERENCE P/No.	SHELL FINISH	CONTACT FINISH
ACPM-RN	55010303-000	NICKEL	NICKEL TIP AND SLEEVE
ACPM-RN-AU	55010303-001	NICKEL	GOLD TIP AND SLEEVE
ACPM-RB	55010303-002	BLACK	NICKEL TIP AND SLEEVE
ACPM-RB-AU	55010303-003	BLACK	GOLD TIP AND SLEEVE

UNLESS OTHERWISE SPECIFIED TOLERANCE TO BE		THIS DOCUMENT IS THE PROPERTY OF AMPHENOL AUSTRALIA PTY LTD. NO PART THEREOF MAY BE REPRODUCED AND USED WITHOUT THE PRIOR WRITTEN CONSENT OF THE OWNER				1 UPDATE ASSEMBLY TO COMPLY WITH MODIFIED COMPONENTS		L.V	10-05-05	8374
LINEAR		ANGULAR		CAD FILE: 55010303000111		0 FIRST ISSUE		L.V	26-08-04	----
X ± 0.5	X ± 1	X'X' ± 30'		DSD: L.V		REV.		BY	DATE	CHG/No
XX ± 0.1	XX' ± 15'	X'X' ± 15'		DATE: 26-08-04		CHANGE DETAILS				
BREAK ALL SHARP EDGES AND REMOVE ALL BURRS		MATERIAL: REFER TO COMPONENTS		CKD: M.N.H		DATE: 17-06-05		TITLE: 1/4" PHONE PLUG RA - MONO CONNECTOR ASSY		
DO NOT SCALE		FINISH: SEE TABLE		APP'D: P.M		DATE: 29-06-05		DRAWING NO. Amphenol Australia Pty Ltd, 2 Fineways Blvd, Keysborough, Vic3173		
DIMENSIONS IN MILLIMETRES		THIRD ANGLE PROJECTION		SCALE: 2:1 UOS		PART No: REFER TO TABLE		SIZE: A3		SHEET 55010303-000-1 1/1

**Amphenol**

Amphenol Australia Pty Ltd, 2 Fineways Blvd, Keysborough, Vic3173

DRAWING NO. 55010303-000-1 SHEET 1/1

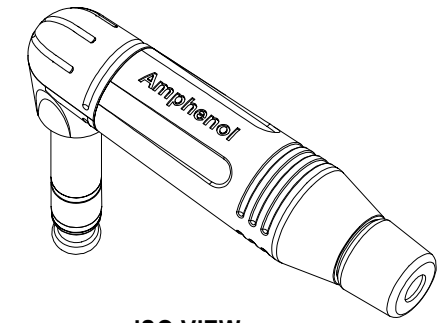

ISO VIEW

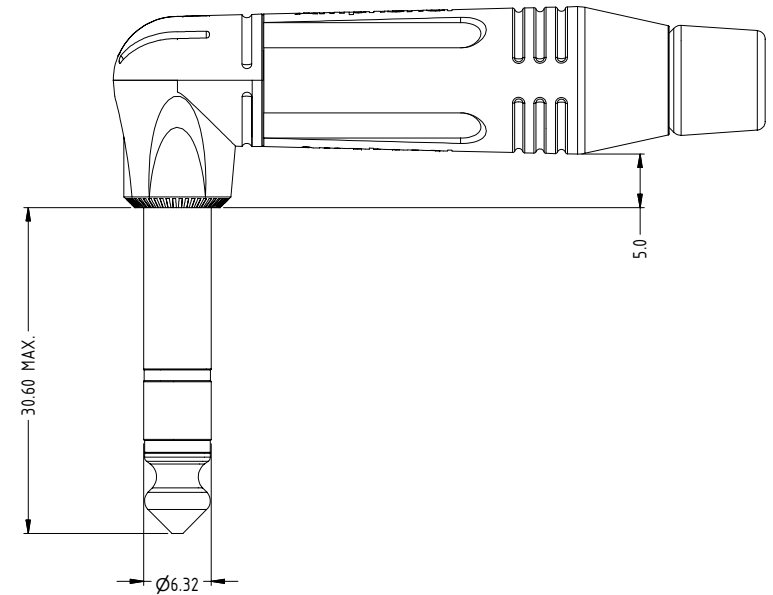
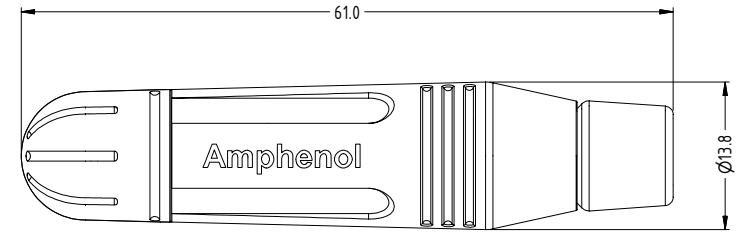
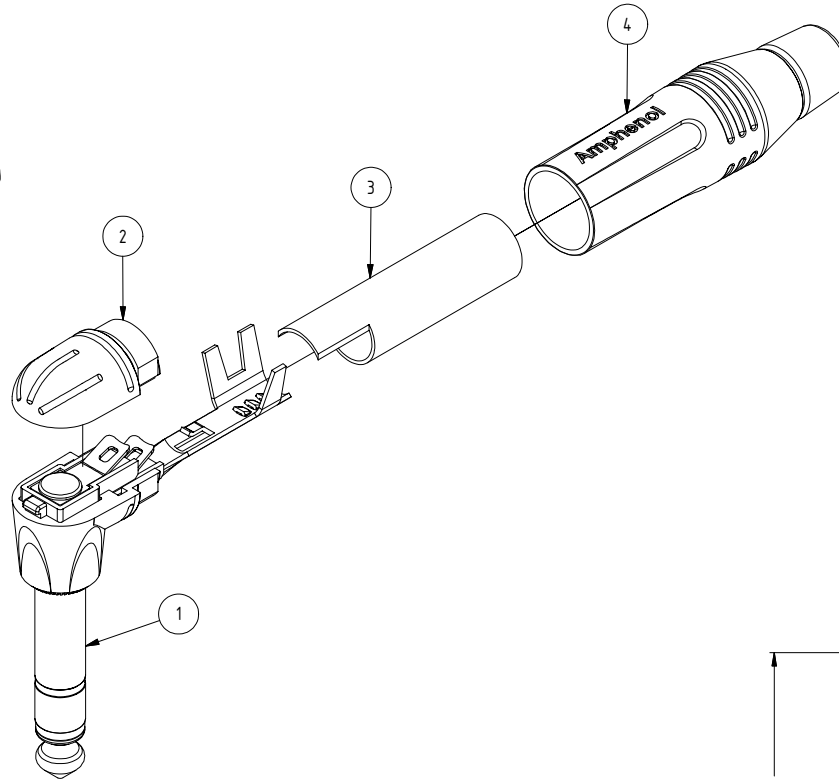
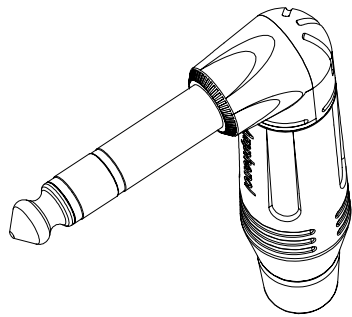

Stereo Connector Assembly - Parts List				
ITEM	PART NUMBER	DWG No	DESCRIPTION	QTY
1	50310027-*30	50310027-130-1	RA-STEREO PLUG INSERT CONTACT ASSEMBLY	1
2	50300105-*21	50300105-121-1	RA-TOP CAP	1
3	51270031-521	51270031-521-1	RA-BIG TUBE PVC INSULATOR	1
4	53490001-*31	53490001-331-1	M-SERIES BACKSHELL ASSEMBLY	1

Part Number according to Shell and Contact Finish			
CATALOGUE P/No.	REFERENCE P/No.	SHELL FINISH	CONTACT FINISH
ACPS-RN	55010302-000	NICKEL	NICKEL TIP, RING AND SLEEVE
ACPS-RN-AU	55010302-001	NICKEL	GOLD TIP, RING AND SLEEVE
ACPS-RB	55010302-002	BLACK	NICKEL TIP, RING AND SLEEVE
ACPS-RB-AU	55010302-003	BLACK	GOLD TIP, RING AND SLEEVE

UNLESS OTHERWISE SPECIFIED TOLERANCE TO BE		THIS DOCUMENT IS THE PROPERTY OF AMPHENOL AUSTRALIA PTY LTD. NO PART THEREOF MAY BE REPRODUCED AND USED WITHOUT THE PRIOR WRITTEN CONSENT OF THE OWNER				1 UPDATE ASSEMBLY TO COMPLY WITH MODIFIED COMPONENTS		L.V	10-05-05	8374
LINEAR		ANGULAR		CAD FILE: 55010302000111		0 FIRST ISSUE		L.V	26-08-04	----
X ± 0.5	X° ± 1	DSD: L.V		DATE: 26-08-04		REV. CHG/No		BY	DATE	CHG/No
XX ± 0.1	XX° ± 30'	MTRL: REFER TO COMPONENTS		CKD: M.N.H		DATE: 17-06-05		TITLE: 1/4" PHONE PLUG RA - STEREO CONNECTOR ASSY		
XXX ± 0.05	XXX° ± 15'	FINISH: SEE TABLE		APP'D: P.M		DATE: 29-06-05		DRAWING NO. 55010302-000-1		
BREAK ALL SHARP EDGES AND REMOVE ALL BURRS		DO NOT SCALE		DIMENSIONS IN MILLIMETRES		SCALE: 2:1 UOS		PART No: REFER TO TABLE		SIZE: A3
		THIRD ANGLE PROJECTION						SHEET 1/1		

**Amphenol**  
Amphenol Australia Pty Ltd, 2 Finlayson Blvd, Melbourne, Vic3123