

PERGOLA

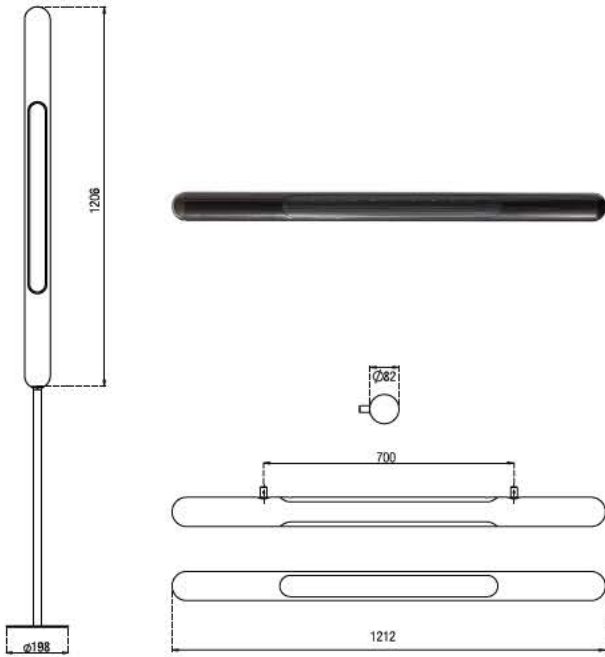

LINE ARRAY SOUND OUTPUT

Speaker type
2" speakers

Nominal impedance
4 Ω

Crossover
DSP needed

Frequency range
150-20.000 Hz (-6dB)
subwoofer needed

Sensitivity (1W-1m)
90 dB

Speaker Peak Power
130W

Speaker RMS Power
65W

Recommended amplifier power
100W (Class D)

POINT SOURCE SOUND OUTPUT

Speaker type
2" speakers; High Freq: horn loaded driver

Nominal impedance
4 Ω

Crossover
external waterproof boxed crossover HI-Pass filter at 100-150Hz 12dB/oct recommended

Frequency range
150-20.000 Hz (-6dB)
subwoofer needed

Sensitivity (1W-1m)
90 dB

Speaker Peak Power
120W

Speaker RMS Power
60W

Recommended amplifier power
100W (Class D)

SPECIFICATIONS

Material
carbon fiber

Mechanic material
stainless steel

Dimensions
82 x 1212 mm

Weight
3 kg

Unpacking: to remove the Pergola from the shipping box carefully follow these steps

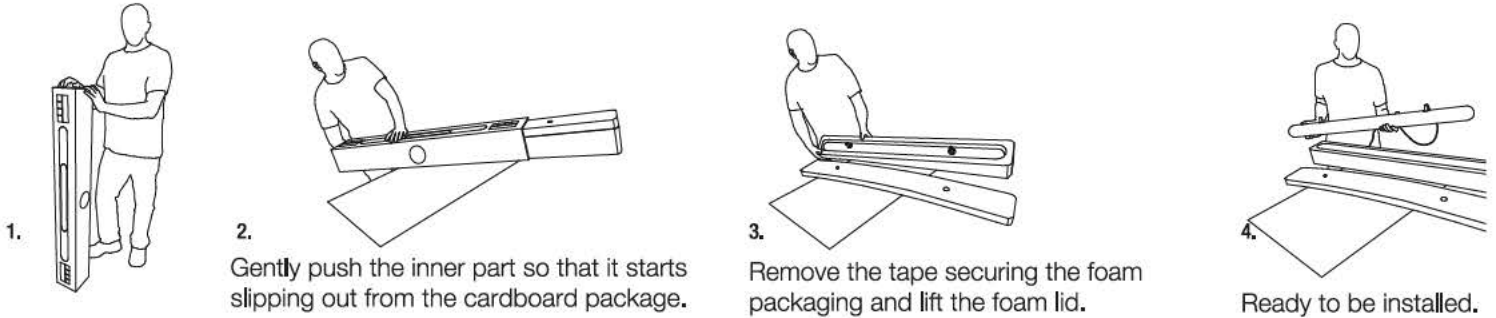

Installation: the Pergola loudspeaker can be installed either indoor and outdoor, on wall, on ceiling or floorstanding; to fix the module use the appropriate mechanic and shown in the images.

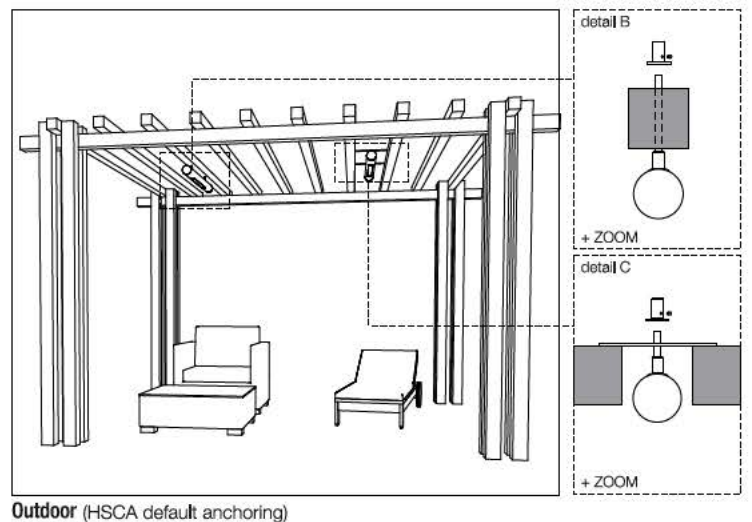
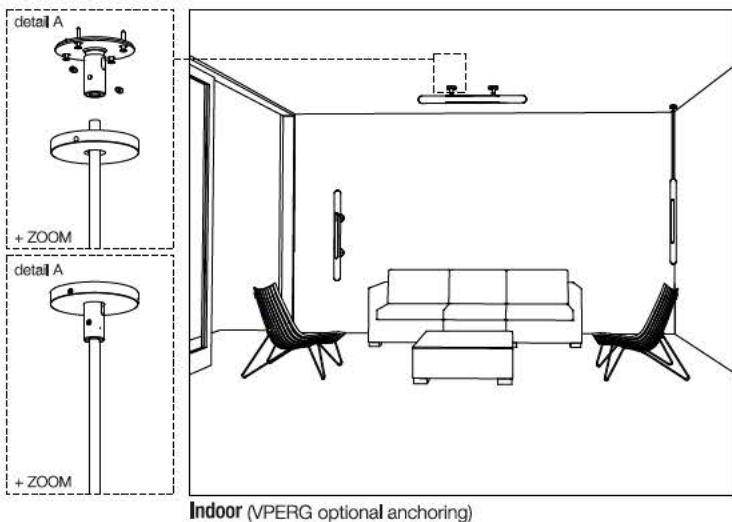

Diffusion and directionality: for the Pergola modules a dual configuration is possible, Line-Array for a large coverage in the horizontal plane in regard to the vertical or Point-Source for a uniform conic coverage.

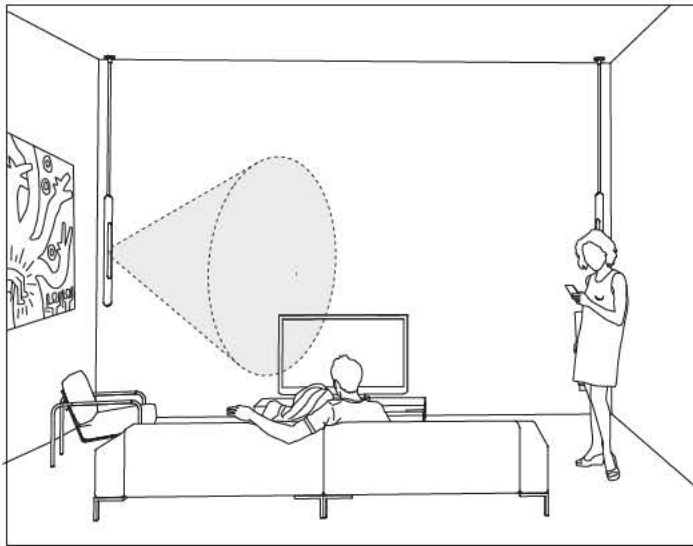

Point-source

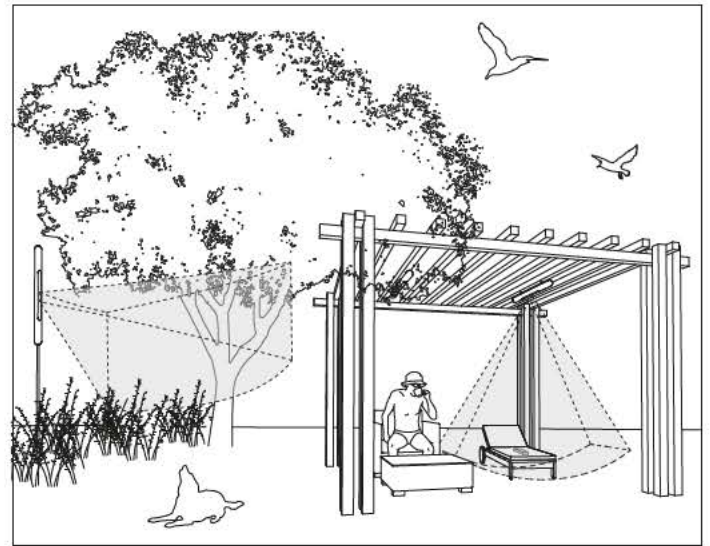

Line-array

Point_Source connection: the Point_Source version of the Pergola sound module requires an external passive crossover, provided by AS in a special box with female Speakon connectors, to be placed near the amplifier or the module. The crossover in the box is equipped with a thermal protection system for the module.

Crossover
external boxed crossover
Hi-Pass filter at 100-150Hz
12dB/oct recommended

Crossover box dimensions
150 x 200 x 75h mm

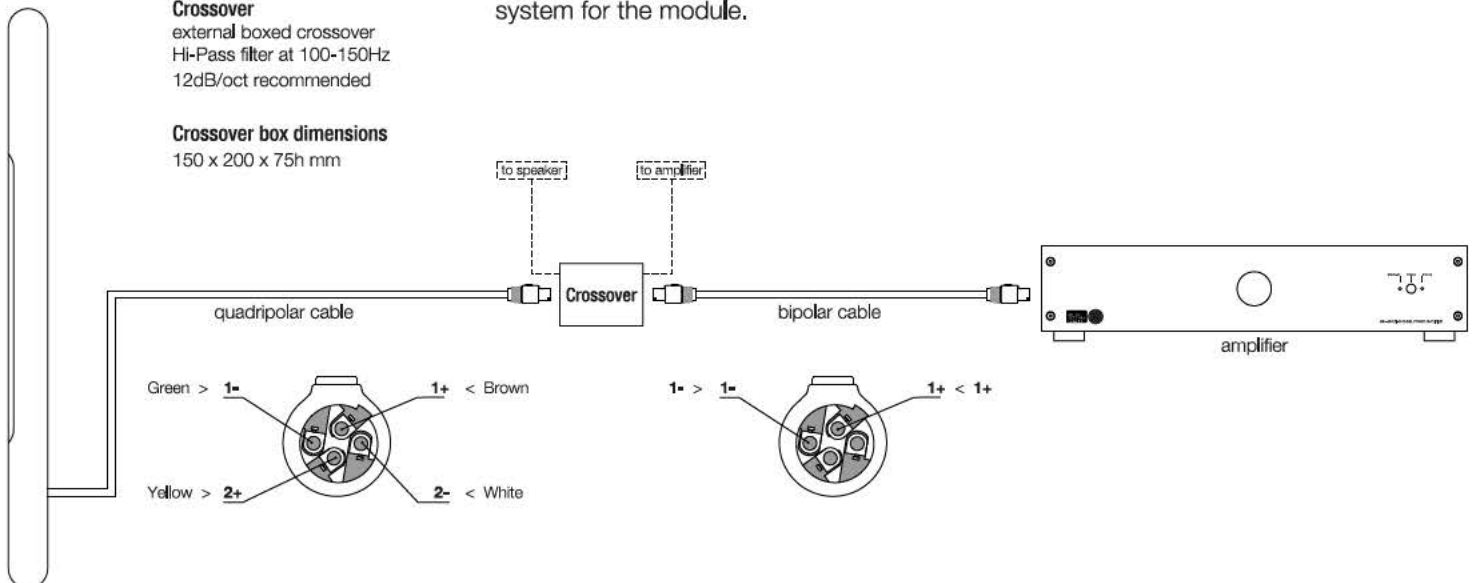

Line_Array connection: the Line_Array version of the Pergola sound module connects directly to amplifier through a bipolar cable.

